

D 52-183

Charles Willing

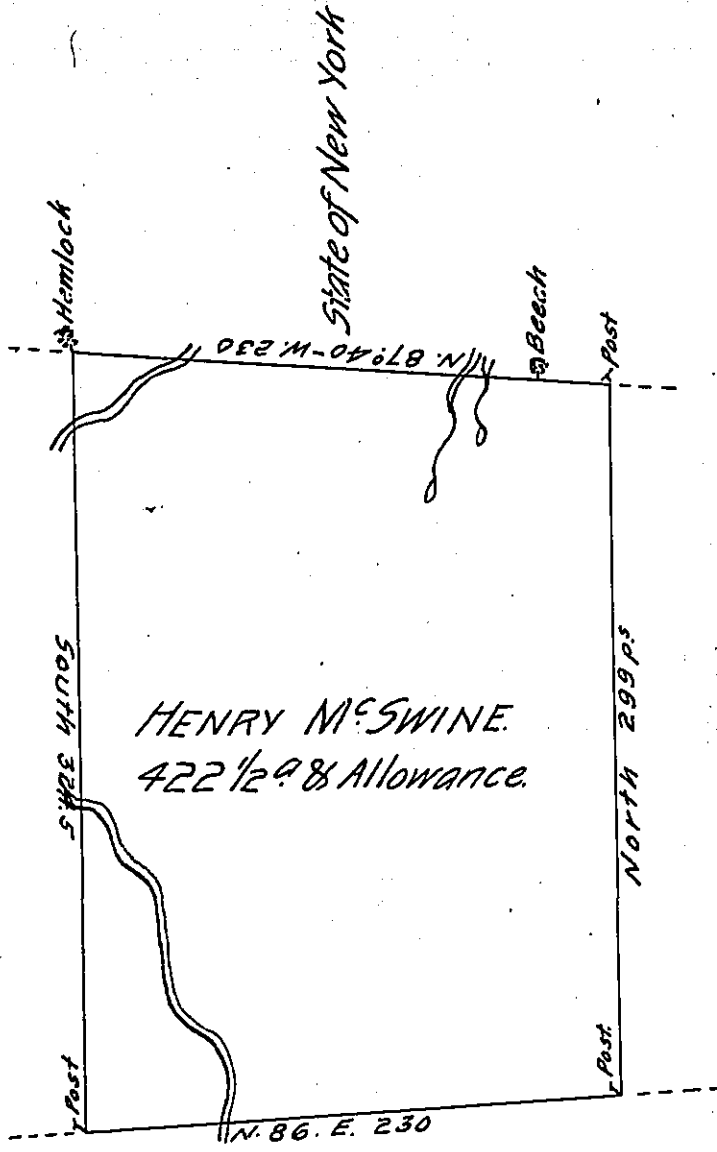

Joseph M. SWINE Pg 248

D-30-284

Edw. A. Laskey

C-119-202

A Draught of a Tract of Land Called \_\_\_\_\_ Situate on the Waters of  
 Choconut Creek, Adjoining Land of Charles Willing and others, in Stoke Township,  
 Northumberland County, Surveyd on the 27<sup>th</sup> day of April 1785, for Henry M. Swi-  
 ne by Virtue of his Warrant dated the 4<sup>th</sup> day of April 1785. Containing  
 four Hundred and Twenty two Acres, and  $\frac{1}{2}$  and allowance of Six  $\frac{1}{2}$  Cent for  
 Roads &c. by

W<sup>m</sup> Gray, D.S.

To John Lukens, Esq. }  
 Surveyor Gen. }

IN TESTIMONY that the above is a copy of the original remaining on file in  
 the Department of Internal Affairs of Pennsylvania, made  
 conformably to an Act of Assembly approved the 16th day of  
 February, 1833, I have hereunto set my Hand and caused  
 the Seal of said Department to be affixed at Harrisburg,  
 this sixth day of February 1906.

*George D. Brown*  
 Secretary of Internal Affairs.